

WIRELESS ARMING STATION

Partcode: LEDRKP/WHITE-WE / LEDRKP/WHITE2-WE

EN50131-1:2006 +A1:2009
EN50131-3:2009
EN50131-5-3:2005 +A1:2008
PD6662:2010

Security Grade (SG) 2 (See Section B Note)
Environmental Class (EC) II



ENGLISH A - H References:

A Learning the Arming Station to the panel.

B Arming Station Options (at the control panel):

- 1 **Tag Reader Enable** - Enables/Disables the tag reader. If the tag reader is not going to be used - disabling it will save battery power (**ENABLE FOR GRADE 2**).
- 2 **Auto Wake-Up** - Wakes the Arming Station (& tag reader) from sleep mode during the entry process/walking the entry route (**ENABLE FOR GRADE 2**).
- 3 **Supervision** - Radio supervision and battery monitoring improve security but can be disabled to save battery power (**ENABLE FOR GRADE 2**).
- 4 **Back-light** - When enabled, this option will illuminate the Arming Station keypad for 5 seconds following any key press.
- 5 **Entry/Exit Sound** - Enables/Disables the entry and exit sounds from the small internal (piezo) sounder on the Arming Station (**ENABLE FOR GRADE 2**).
- 6 **Default Level** - This option controls the default level that will be pre-selected when you start to Set or Unset using the Arming Station.
- 7 Enter a name for the Arming Station and then its location.

C The Icon Window:

IMPORTANT NOTE: At this stage it is critical that you choose the correct icon window for your region (UK or EXPORT). The LEDs behave differently due to software differences between regions - as such, the icon windows are **NOT INTERCHANGEABLE** and any system that had the wrong window fitted would not meet certification standards. Select the correct window and clip it into place.

- 1 **UK Status LEDs** - These mirror the status LEDs on the UK Control Panels.
 - 2 **The Tag Reader** - This Icon will illuminate when the reader is active.
 - 3 **EXPORT Status LEDs** - These mirror the status LEDs on the Export Control Panels.
- NOTE:** The black (UK) Icon Window is shown in section 'D' onwards, please be aware that this is for diagrammatic convenience only. Please ensure you fit the correct Icon Window for your region.

D Setting & Unsetting:

- 1 **NOTE:** The Arming Station may already be 'awake' due to the Auto-Wakeup option if you have just entered your property (entry route) - see section 'B-2'.
- 2 Swipe your Tag against this reader icon or enter your user code (e.g. Export default User Code: 1 2 3 4 - UK Default Master Manager code: 2 2 2 2).
- 3 Select the Level you wish to Set or Unset (this will illuminate the key red).
- 4 Finally, press the 'Tick' Icon to begin the Setting or Unsetting sequence.

E Output Control:

- 1 **UK Panels:** Press the 'D' Key and then enter your Master Manager or User code.
Export Panels: Simply press the 'A' Key (no code entry required)
- 2 The 1-4 keys will illuminate green - these correspond to the Outputs 1-4.
- 3 Press whichever of the 1-4 keys is required in order to switch the desired output.

F Battery Replacement:

To avoid damage to internal components - touch a grounded/earthed metal conductor such as a nearby radiator/piping. With the case open (see start of these instructions for case opening), disconnect the battery connector and pull the ribbon (as shown) to dislodge the battery. Replace only with a Pyronix 'BATT-ES1' as supplied. Dispose of old batteries in accordance with your local regulations.

G Diagnostics battery test:

This test will return a 'good' or 'replace' result after testing the internal battery.

H Signal Strength Check:

Go to the menu path shown, and the Arming Station will illuminate its LEDs to indicate signal strength. The RED LED means that the signal strength is bad - do not install unless a GREEN LED is displayed. Please be aware that the AMBER LED may flash throughout this process, depending on your system configuration - ignore the AMBER LED - only the RED and GREEN LEDs are relevant to signal strength.

IMPORTANT NOTE: If you change the case plastics to one of the metallic colours available for the wired keypad - this will significantly reduce the wireless range & signal strength. We strongly advise against this.

Specification

Battery: 1x BATT-ES1 (CP405050-P2, 3.0V, 4700mAh LiMnO₂)
Dimensions: 144 x 99 x 34mm
EN50131: Certified Grade 2
Temperature: Storage: -10°C to 40°C
Maximum Operating Humidity: 85% @ 25°C
Transmission: 868Mhz FM Transceiver Narrow Band (range 300m in free space)
Transmission Method: Fully Encrypted Rolling Code
Low Battery Threshold: 2.4V
Weight: 257g
Indication: LEDs (Alert, Alarm, Tamper, Fault, Unset)

Warranty

This product is sold subject to our standard warranty for period of two years (excluding battery) see www.pyronix.com/warranty for further details.

Product Warning Information

For electrical products sold within the European Community. At the end of the electrical products life, it should not be disposed of with household waste. Please recycle where facilities exist. Check with your Local Authority or retailer for recycling advice in your country. The battery must be disposed of separately and in accordance with local regulations.

Compatibility - Up to 4 Arming Stations can be learned to these panels:

Enforcer 32-WE; >V9.5, EURO 46 APP (requires EURO ZEM32-WE); >V2.11,
HomeControl+; >V2.1, PCX 46 APP (requires PCX RIX32-WE); >V10.3

START

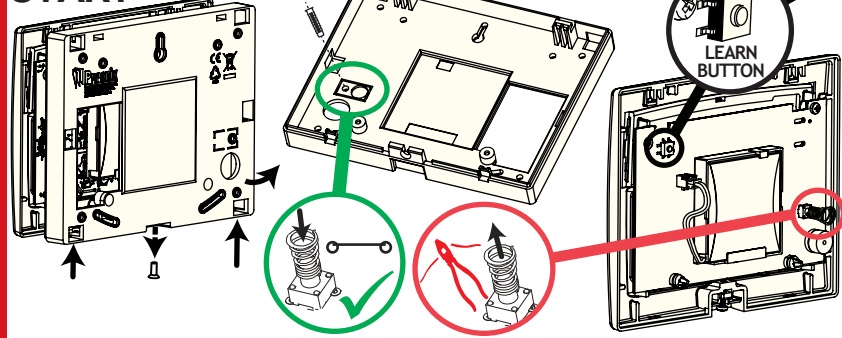

A Learning to the Control Panel

ENTER ENGINEERS MENU AND SCROLL TO:

UK MENU	EXPORT MENU
WIRELESS DEVICE CONTROL? YES	LEARN WIRELESS DEVICES? YES
Control Arming Stations? YES	Learn Arming Stations? YES
Learn Devices? YES	Learn Devices? YES
Select Arm Stat Available [1]	Select Arm Stat Available [1]

EXPORT MENU
LEARN WIRELESS DEVICES? YES
Learn Arming Stations? YES
Learn Devices? YES
Select Arm Stat Available [1]

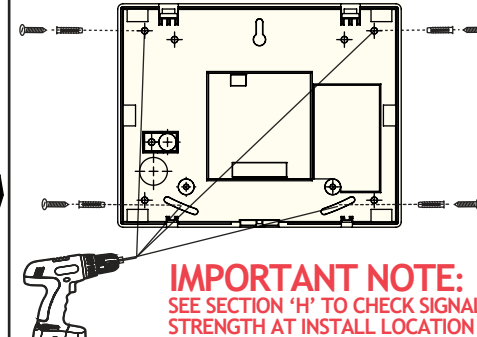
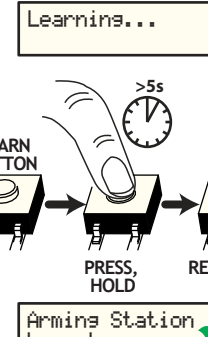

B Settings/Options:

ENTER ENGINEERS MENU & SCROLL TO:

UK MENU	EXPORT MENU
ASSIGN KEYPADS/READERS? YES	INSTALL KEYPADS/READERS? YES
Arming Address 1 Station 1 [4]	Type Arming Stat [3]
Options? YES	

1 Tag Read Enable Yes [1]	6 Default Level [A]
2 Auto Wakeup Yes [1]	Set Point Description? YES
3 Supervision No [0]	7 Enter Name Station 1
4 Back Light No [0]	Enter Location YES
5 Entry/Exit Sound No [0]	

IMPORTANT NOTE: B2, B3 & B5 MUST be set to "Yes" for Security Grade 2 compliance.

C The Icon Window:

UK WINDOW				
Alert AMBER	Alarm RED	Tamper RED	Fault AMBER	Unset GREEN

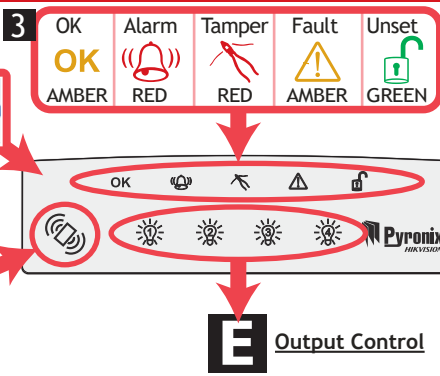
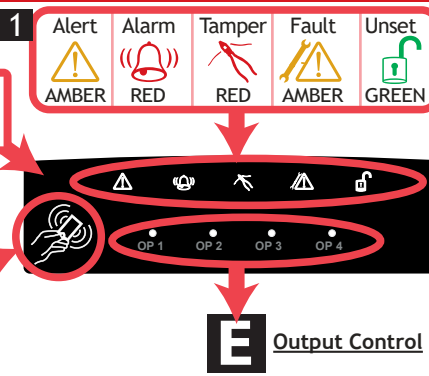

D Setting & Unsetting:

- 1 If you use a tag to set / unset, first, press any key to wake the arming station. If not, skip to step 2 and simply enter your code.

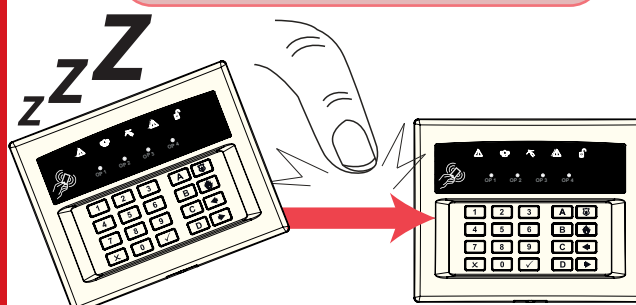

- 2 Swipe your tag against the reader OR enter your user code.

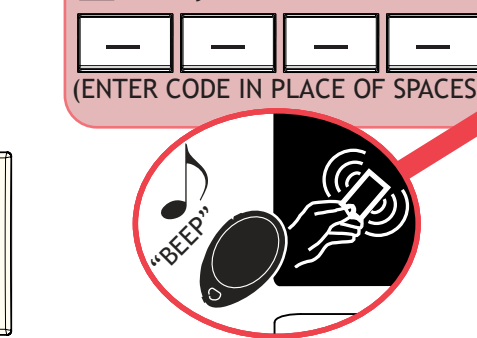

NOTE: STEP 3 & 4 WILL ONLY HAPPEN DURING SETTING AND IF 'FLEXI-SET' IS ENABLED - OTHERWISE SETTING/UNSETTING WILL BEGIN AFTER STEP 2

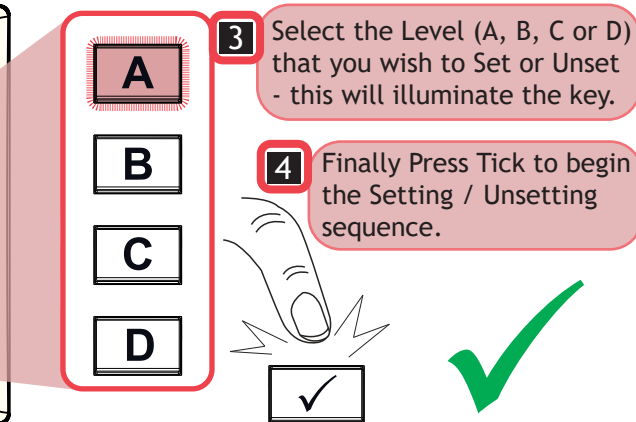
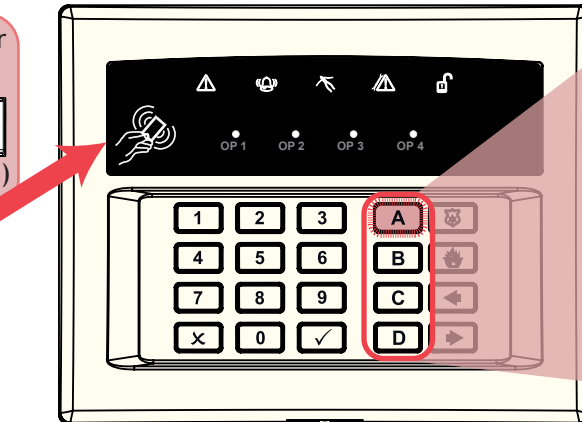

E Output Control:

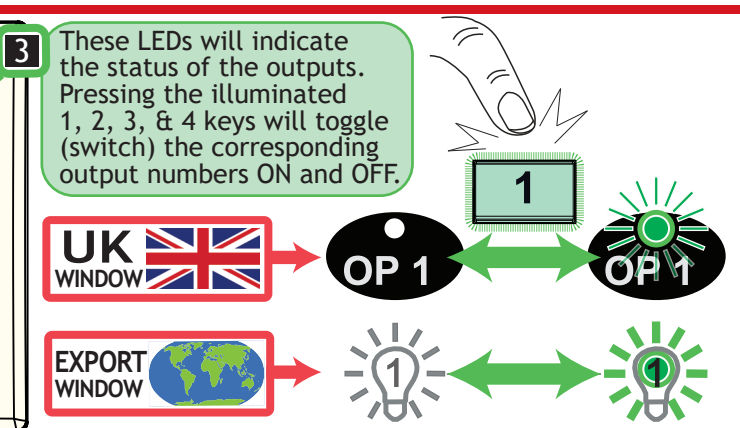
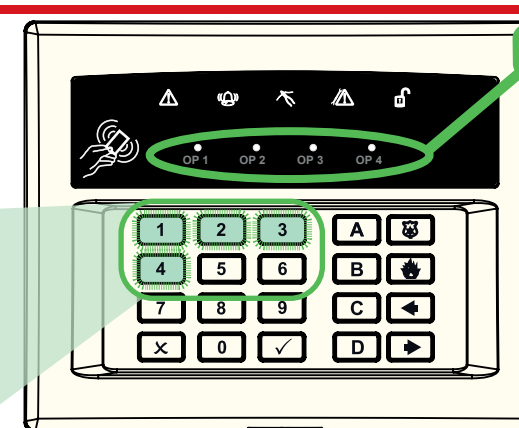
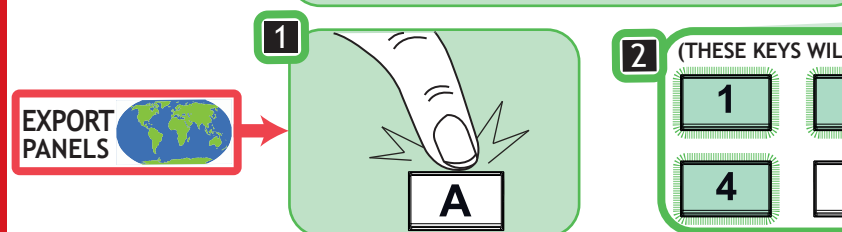
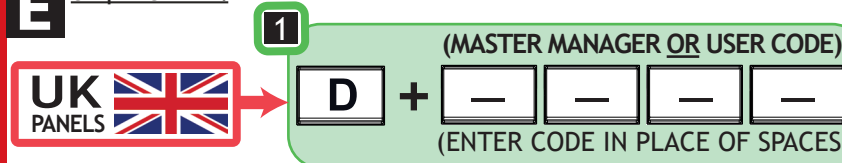

F Battery Replacement:

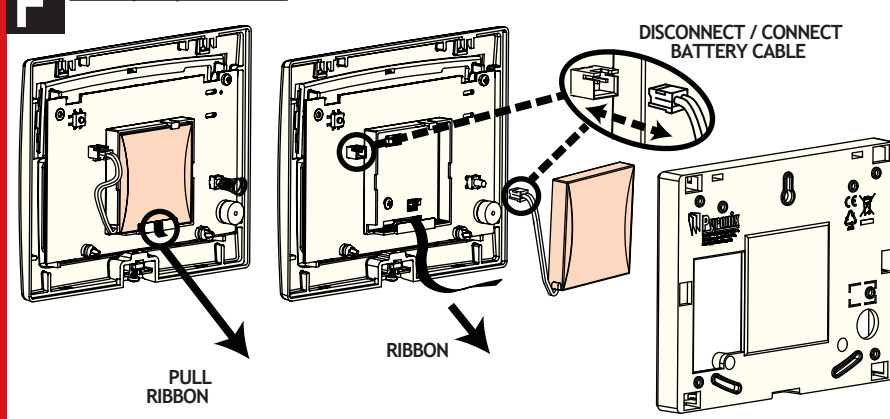

G Diagnostic battery test:

ENTER ENGINEERS MENU & GO TO:

DIAGNOSTICS? YES	Wireless Devices YES	View Inputs? NO	View Arming Stat Battery Status? YES
Arming Stat [1] Good	Arming Stat [1] Replace		

SEE SECTION 'F' TO REPLACE BATTERY IF THIS TEST STATES 'REPLACE'

H Signal Strength test:

ENTER ENGINEERS MENU & GO TO:

DIAGNOSTICS? YES	Wireless Devices YES	View Inputs? NO	View Arming Stat Signal Strength? YES
3---	Arming Stat [1] Excellent [100]		

GOOD SIGNAL - OK TO INSTALL

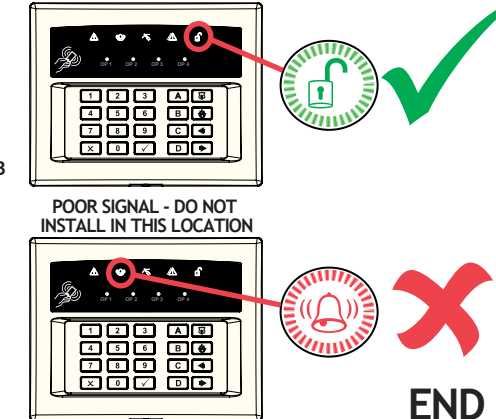

POOR SIGNAL - DO NOT INSTALL IN THIS LOCATION

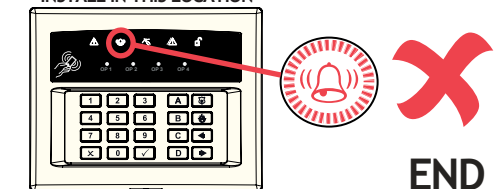

END